



SIGNATURE  
COLLECTION



# vista

DUAL-GLAZED  
SLIDING WINDOW

**FEATURES:**

**Traditional design** with softened and rounded frame and sash

**Reinforced interlock design** for security and strength

**3 1/2" frame depth** to fit into narrow wall assemblies

**Low profile design** for maximum viewing area



WEST COAST  
WINDOWS™  
— EST 1976 —

DESIGNED FOR LIFE™

# vista DUAL-GLAZED SLIDING WINDOW

Performance and value meet with creative, contemporary slider design. Both horizontal and vertical slider configurations utilize our signature low-profile frame, offering a greater area of glass, increasing light filtration and view area. The performance of the **Vista Series Window** is further enhanced with a reinforced frame, interlocking T-bar and a uniquely designed double weather seal that keeps the cold out and the heat in. Vista sliders windows are easy to open, easy to clean and provide maximum ventilation. A secure locking system, reinforced with metal, ensures added peace of mind and consistent performance.

1. Double weather seal
2. Fusion welded frame & sash
3. S-channel interlock
4. 4 Torlon rollers
5. Triseal Super Spacer
6. Canadian u-PVC (Vinyl)
7. Metal reinforcing

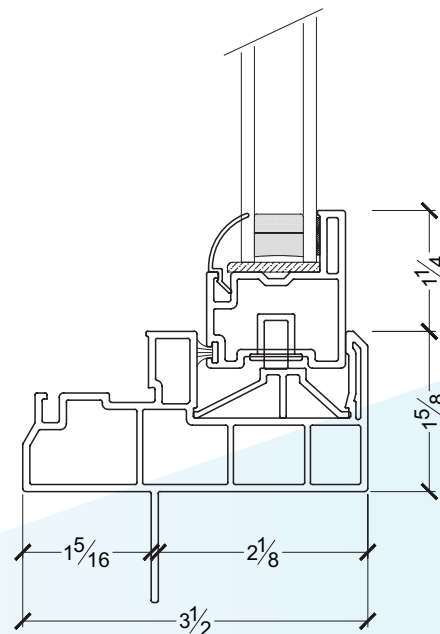
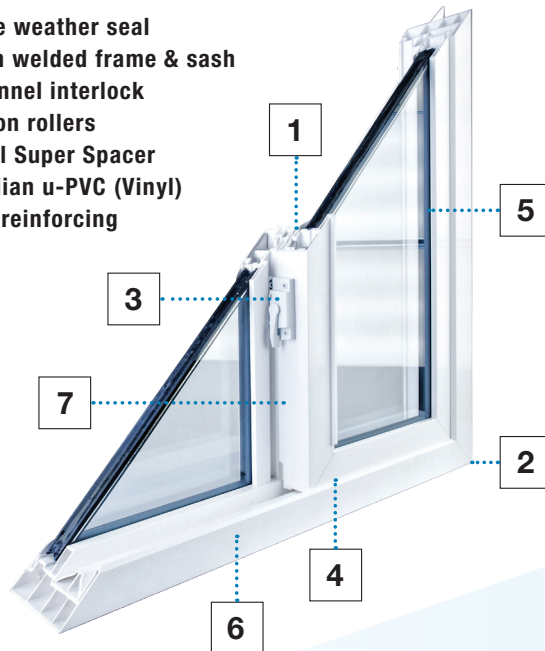

## PERFORMANCE DATA

**Picture window:** Light Commercial  
Classification. Performance Grade = PG 75

**Sliding window:** Light Commercial  
Classification. Performance Grade = PG 55

**Single-hung window:** Light Commercial  
Classification. Performance Grade = PG 75

Style	U Value	SHGC	VT	Glazing Make Up	Performance
Ver. Slider	1.59	0.22	0.50	LoE-366 / Clear	Good
Hor. Slider	1.60	0.22	0.50	LoE-366 / Clear	Good
Picture	1.45	0.24	0.57	LoE-366 / Clear	Good
Ver. Slider	1.39	0.32	0.55	LoE-272 / LoE i-89	Better
Hor. Slider	1.42	0.32	0.56	LoE-272 / LoE i-89	Better
Picture	1.23	0.35	0.61	LoE-272 / LoE i-89	Better
Ver. Slider	1.36	0.22	0.50	LoE-366 / LoE i-89	Best
Hor. Slider	1.38	0.22	0.50	LoE-366 / LoE i-89	Best
Picture	1.19	0.24	0.55	LoE-366 / LoE i-89	Best

OTHER GLAZING OPTIONS ARE AVAILABLE

**UNLIMITED LIFETIME WARRANTY ON VINYL, GLASS AND HARDWARE. INCLUDING ALL PARTS, LABOUR AND CRAFTSMANSHIP. WARRANTIES ARE TRANSFERABLE TO NEW OWNERS FOR 25 YEARS.**